

The Derby Steel™ Welded Single Bunk

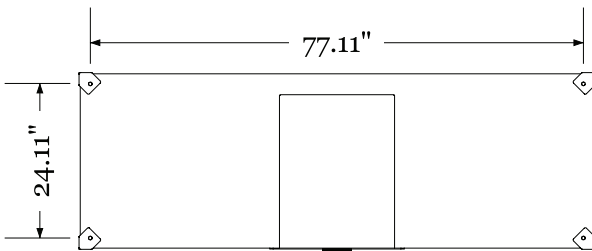

MOUNTING HOLE PATTERN DIMENSION
(27" x 80" INSIDE BED PAN DIMENSION)

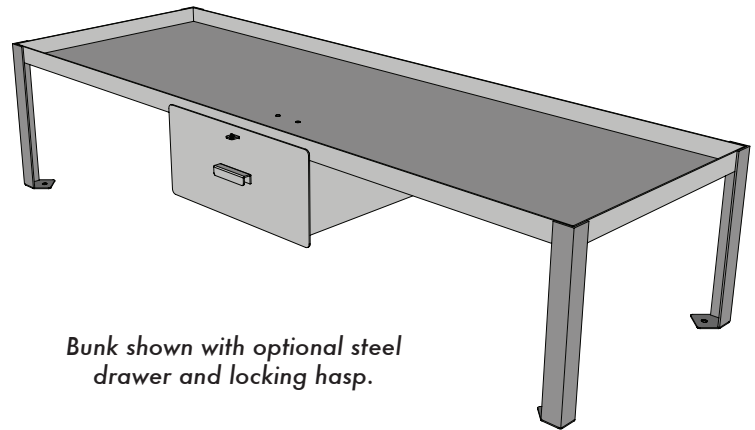

*Bunk shown with optional steel
drawer and locking hasp.*

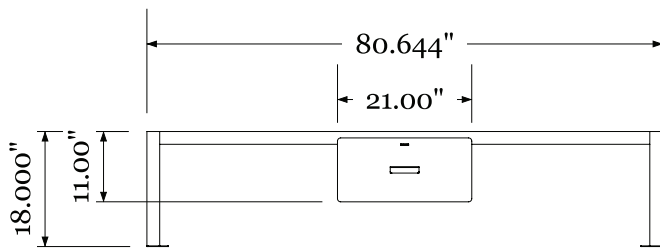

FRONT

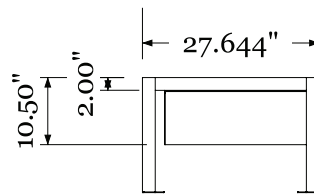

SIDE

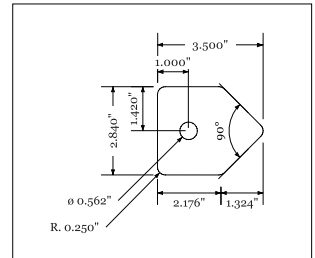

FLOOR MOUNT DETAIL

OVERVIEW

Heavy duty steel bunk intended for sleeping areas in correctional environments.

FABRICATION

Laser cut and welded steel bed pan. All bunks have a baked-on polyester powder coat semi-gloss finish. Slide rails and drawers are constructed from welded steel. Welded steel hasp for securing drawer with a padlock if desired.

MATERIAL - OPTIONS AS SHOWN

- 27" x 80" 10 gauge steel pan.
- 2" x 2" x 3/16" standard angle steel legs.
- 12 gauge floor mounting tabs with 9/16" diameter holes are provided for welding or bolting to the floor.
- 18" x 24" steel drawer has a 12 gauge body with a 10 gauge faceplate and handle.
- 10 gauge security hasp.
- 12 gauge slide rails.
- 2" x 2" x 3/16" standard angle drawer stops.

COLOR

Vitracoat T.K. Gray.

WEIGHT

TBD

OPTIONS

- Steel drawers (please specify one or two when ordering).
- Locking hasps.
- Rail slides for property boxes.
- Prime coat.
- 12 gauge steel w/hemmed bed pan edges.
- Custom sizes available.

ASSEMBLY

No assembly required.

INSTALLATION

Weld or bolt unit to wall plates or bolt to floor.*

WARRANTY

1 year limited replacement warranty.

MAINTENANCE

Easy clean up with a damp cloth and mild detergent.

*Floor and wall mounting hardware not included.

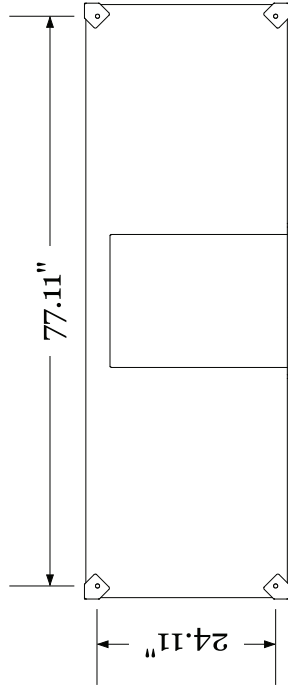

MOUNTING HOLE PATTERN DIMENSION
(27" x 80" INSIDE BED PAN DIMENSION)

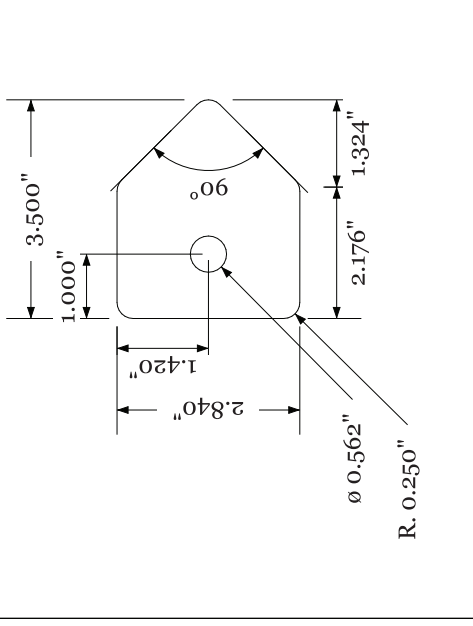

FLOOR MOUNT DETAIL

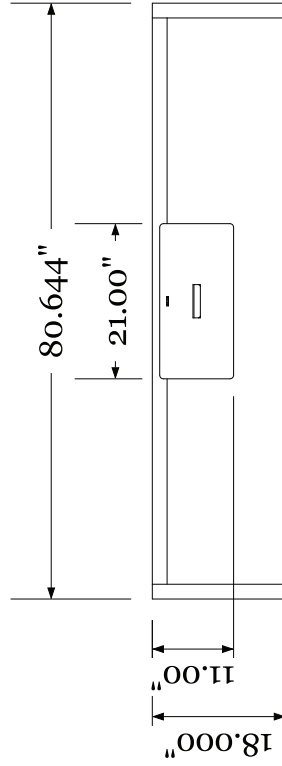

FRONT

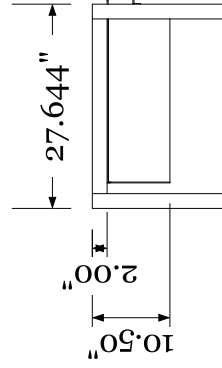

SIDE

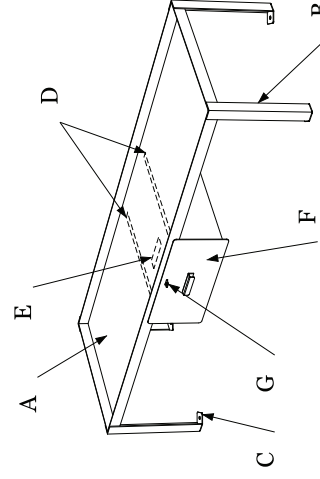

ITEM	DESCRIPTION	QTY
A	BED PAN, SHEET METAL, 10 G. HRPO (OPTIONAL, 12 G. w/HEMMED EDGES)	1
B	BUNK LEG, STRUCTURAL ANGLE, 2" x 2" x 3/16"	4
C	FLOOR MOUNT, SHEET METAL, 12 G. HRPO	4
D	SLIDE RAILS, SHEET METAL, 12 G. HRPO	2
E	SECURITY STOP, STRUCTURAL ANGLE, 2" x 2" x 3/16"	1
F	DRAWER, SHEET METAL, 10 G. & 12 G. HRPO	1
G	HASP, SHEET METAL, 10 G. HRPO	1

DERBY INDUSTRIES

27" x 80" Single Floor Bunk Frame
w/Optional Drawer

REVISIONS	
MM/DD/YY	REMARKS
1	...
2	...
3	...
4	...
5	...

STANDARD TOLERANCES .X = ±.12° .XX = ±.06° .XXX = ±.03° ANGLE = ± 1°